



- Rated load: 125A at 60VDC
- 120VDC with magnet arc blow-out option
- Auxiliary contact option
- SPST, SPDT, DPST-NO versions
- Motor reverser
- Bi-stable (Latching) option - SPST only



Contacts

Contact arrangement	SPST-NO-DM, SPDT, DPST-NO-DM, DPDT
Contact material	AgCu Alloy
Max. switching voltage	DC 60V, 120VDC with magnet arc blow-out option
Rated load (resistive, $\cos \phi=1$)	DC1 125A 60VDC
Working duty	non latch Continuous
Terminal temperature rise above ambient	<70°C. IEC EN60947, GB14/14048.4
Contact voltage drop	max. $\leq 80\text{mV @ } 125\text{A}$
Auxiliary Contact (when fitted)	arrangement SPST-NO (1 Form A)
	max. current 5A @ 24VDC / 2A @ 48VDC
	min. current 100mA @ 5V

Coil

Nominal Voltage (see page 2)	DC 12 ~ 120VDC (Tables 1 & 2)
Rated power consumption	hold 5 ~ 9W (non-latching type)
	initial 20 ~ 35W (latching)
Working duty	latch coil continuous
Minimum pulse length	latch coil 200ms
Maximum operating frequency	non-latch 6 ops./min. square wave pulse

Insulation

Insulation resistance	Initial 100M Ω (min.) @500VDC
Dielectric strength	coil to contact 1000V _{rms} (50/60Hz) / <1mA / 1 min (at sea level)
	contact to contact 1000V _{rms} (50/60Hz, 1min, <1mA leakage)

General Data

Operate / bounce time at 20°C	max. 30ms / 3ms
Release time	max. 30ms
Electrical life	at rated load 20,000 ops
Mechanical life	no load 100,000 ops

Environmental

Ambient temperature	operating -25°C to +65°C (Latching), +85°C (non-Latching)
Shock resistance	20g peak, 11ms 1/2 sine
Vibration resistance	3g sine peak (1-50Hz 0.5mm amplitude)
Relative humidity	RH 20% ~ 90%
Dimensions	L x W x H Various - see dimensional drawings
Weight	approx. Various according to option and style (c.380g)

Ordering Code

D S C 1 2 M - 4 0 2 1 - 2 8 - 1 0 2 4 - S D W

DSC Series

12: Standard

12M: Magnet arc blow-out¹

Coil codes

See tables 1 & 2

Contact arrangement

4011: SPDT (C/O) (1 Form C (1Z) non latching)

4012: Motor reverser (2 Form C (2Z) non latching)

4021: SPST-NO (1 Form A (H) and latching SPST)

4022: DPST-NO-DM (2 Form A (2H) non latching)

Body style

28: Open frame, male stud terminals

Accessory options

Blank: No option

C: Dust cover IP40 (4021 contact option only)

S: Auxiliary switch

D: Parallel back emf diode suppression (standard coils)

T: Parallel TVS back emf suppression diode (bi-stable coils)

Mounting & terminations

Blank: No bracket

W: 'W' shaped mounting bracket

1L: 'L' shape mounting bracket (4021 & 4022 contacts only)

2L: 2 x 'L' shape mounting brackets (4021 & 4022 contacts only)

2P: 2 x 'P' shaped mounting brackets (not 4012 contacts)

¹ DSC12M not available for 4012 or 4022 contact options

Coil Data - Standard (monostable) coil

Table 1

Coil code	Nominal voltage U_s (VDC)	Recommended coil operating range (V)	Must operate max. voltage (VDC)	Must release voltage min. (VDC)	Starting current (A)	Coil power (W)
1012	12	0.85 U_s ~ 1.2 U_s	≤ 8.4	≥ 1.2	≤ 1.0	5 ~ 9W
1024	24		≤ 16.8	≥ 2.4	≤ 0.6	
1030	30		≤ 21.0	≥ 3.0	≤ 0.6	
1036	36		≤ 25.2	≥ 3.6	≤ 0.5	
1048	48		≤ 33.6	≥ 4.8	≤ 0.3	
1060	60		≤ 42.0	≥ 6.0	≤ 0.25	
1072	72		≤ 50.4	≥ 7.2	≤ 0.2	
1080	80		≤ 56.0	≥ 8.0	≤ 0.15	
1096	96		≤ 67.2	≥ 9.6	≤ 0.15	
1120	120		≤ 84.0	≥ 12.0	≤ 0.15	

Coil Data - Single coil latch (bi-stable). Reverse polarity through coil to unlatch. SPST only

Table 2

Coil code	Nominal voltage U_s (VDC)	Recommended coil operating range (V)	Must operate max. voltage (VDC)	Must release voltage min. (VDC)	Starting current (A)	Coil power (W)
SL12	12	0.85 U_s ~ 1.2 U_s	≤ 9.6	≤ 9.6	≤ 2.0	Initial 20 ~ 35W Pulse length 0.5 ~ 1 sec.
SL24	24		≤ 19.2	≤ 19.2	≤ 1.0	
SL30	30		≤ 24.0	≤ 24.0	≤ 0.70	
SL36	36		≤ 28.8	≤ 28.8	≤ 0.50	
SL48	48		≤ 38.4	≤ 38.4	≤ 0.40	
SL60	60		≤ 48.0	≤ 48.0	≤ 0.40	
SL72	72		≤ 57.6	≤ 57.6	≤ 0.35	
SL80	80		≤ 64.0	≤ 64.0	≤ 0.35	
SL96	96		≤ 76.8	≤ 76.8	≤ 0.30	
SL120	120		≤ 96.0	≤ 96.0	≤ 0.25	

Other coils available upon special request. MOQ's will apply.

Dimensions (mm)

Fig. 1

SPST-NO-DM DSC12-4021-28-10**

SPST DSC12-4021-28-SL**

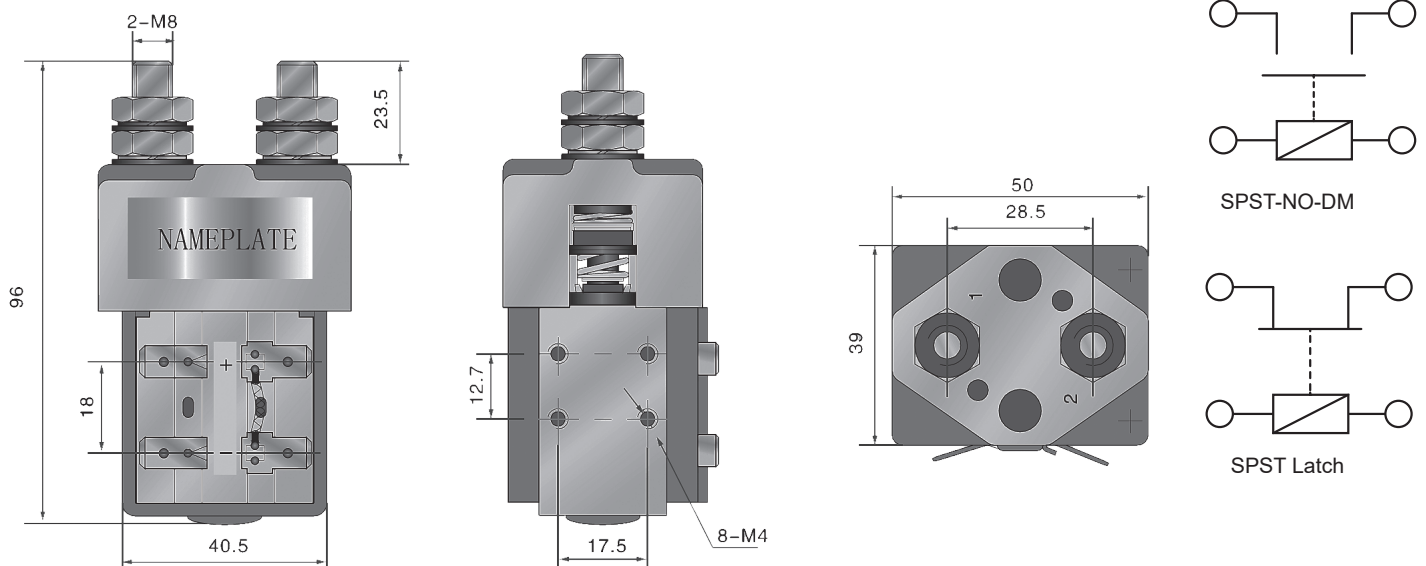

Dimensions (mm)

Fig. 2

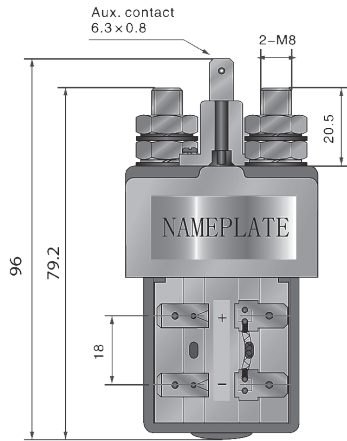

SPST DSC12-4021-28-****-S

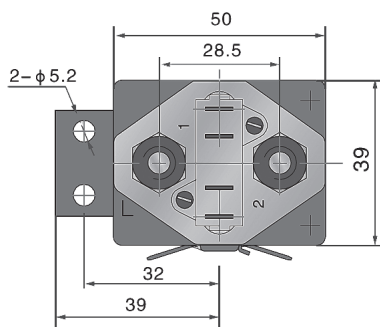
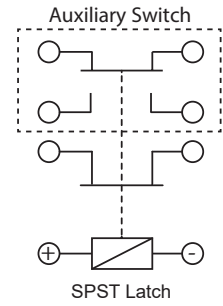
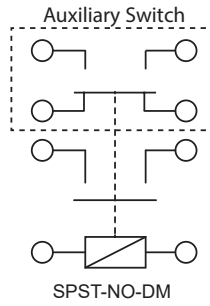

with optional "L" shaped bracket

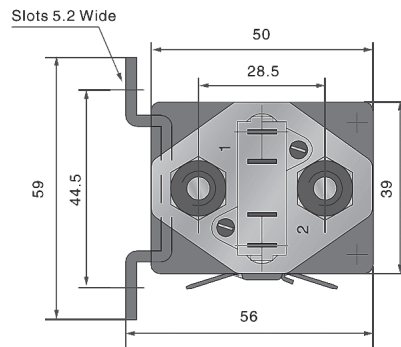

with optional "W" shaped bracket

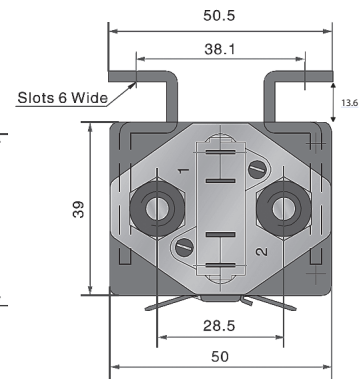

with optional 2 x "P" shaped brackets

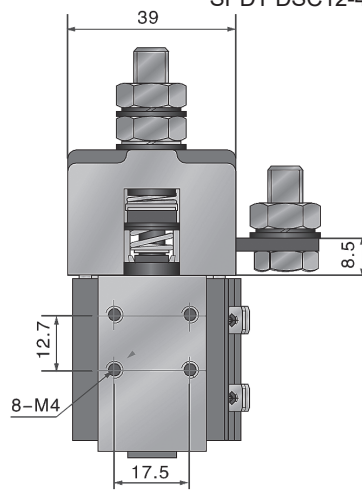
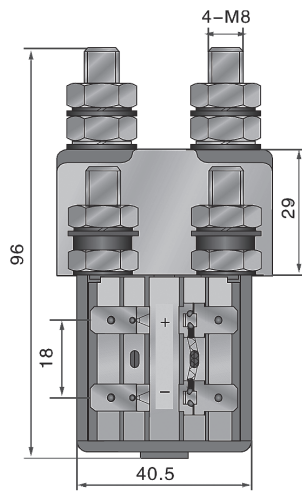

SPDT DSC12-4011-28-****

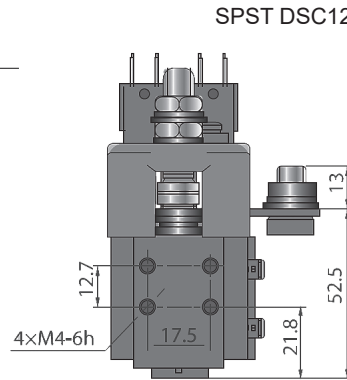
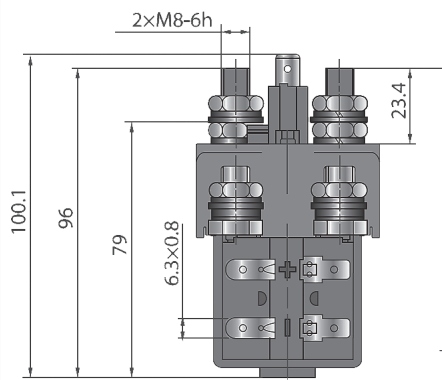
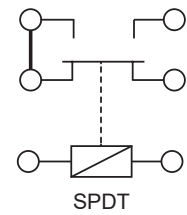
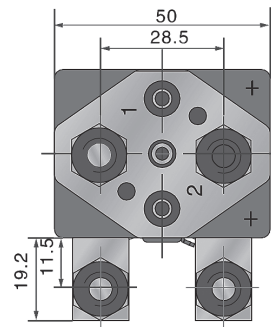

SPST DSC12-4011-28-****-S

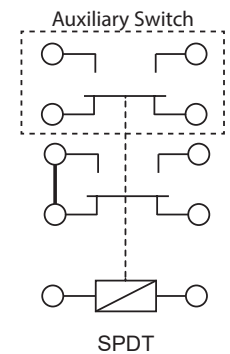
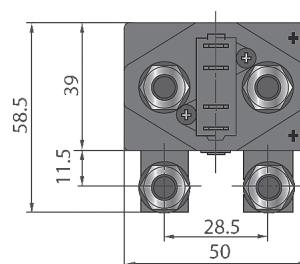

Dimensions (mm)

Fig. 3

DPST DSC12-4022-28-****

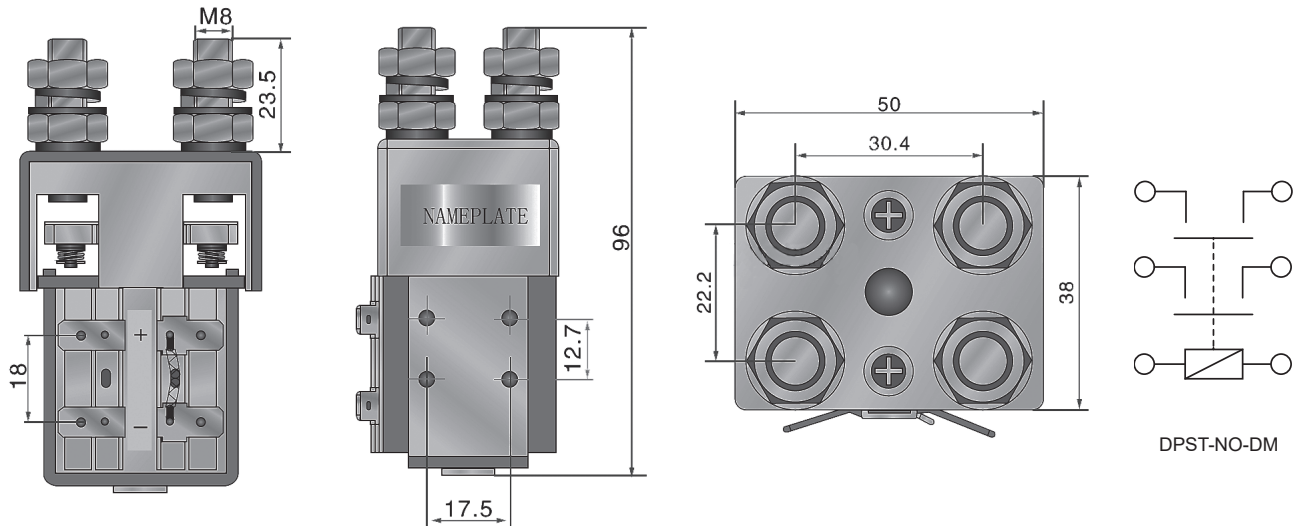

DPDT DSC12-4012-28-****-W

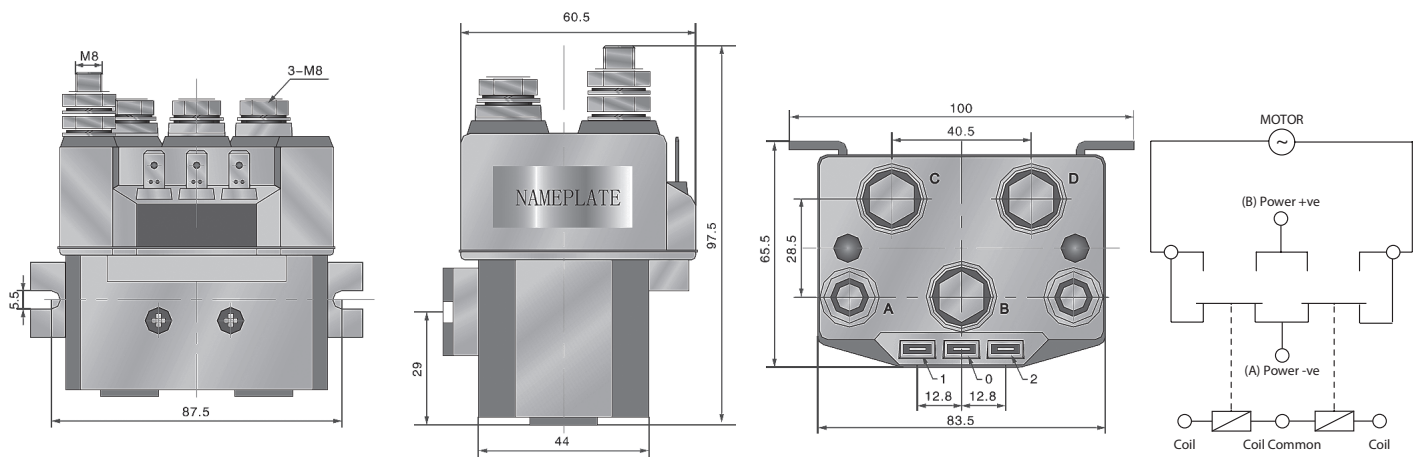

Motor Reverser with optional "W" bracket